

### Installation Instructions

#### INSTRUCTIONS PERTAINING TO A RISK OF FIRE, OR INJURY TO PERSONS. IMPORTANT SAFETY INSTRUCTIONS

#### Warning! To reduce the risk of FIRE OR INJURY TO PERSONS:

1. Do not touch luminaire while lamp is on. Turn off/unplug and allow to cool before replacing lamp.
2. Lamp gets HOT quickly! Contact only switch/plug when turning on.
3. Do not touch hot lens, body, cap, or knuckle.
4. Keep lamp away from materials that may burn.
5. Do not touch lamp at any time. Use a soft cloth. Oil from your skin may damage lamp.
6. Do not operate the luminaire with damaged or missing parts.
7. Do not disassemble luminaire beyond cap removal to facilitate lamp and/or accessory installation or replacement
8. Remove any debris accumulated in the cap periodically.
9. Do not install luminaire within 10 feet of a pool, spa, or fountain.
10. **This luminaire must be used with an approved Vision3 Lighting Ballast, otherwise, damage may result.**
11. Have fixture installed in accordance with all applicable installation codes and standards by a person familiar with the construction and operation of the fixture and the hazards involved.

#### SAVE THESE INSTRUCTIONS

#### Installation:

Install fixture by threading/inserting the Threaded Nipple into the mount hole of an appropriate mounting option/ballast. Use Lock Nut to secure fixture to mount option. See mount option/ballast installation instructions for further installation procedures.

**Caution!** The leads from this fixture should be attached to the output of an approved ballast only! Otherwise, damage or injury may result.

**Caution!** Fixture will be hot if lamp is on. Remove power and allow fixture to cool before performing any adjustments or maintenance.

#### Vertical Adjustment of Fixture:

1. Loosen the Vertical Adjustment Screw using a 3/16" hex tool – do not remove screw!
2. Grab fixture Body and gently push/pull to break grip of tapered knuckle lock.
3. Slightly tighten Vertical Adjustment Screw using the 3/16" hex tool, so that fixture holds position when released, but still moves when adjusted.
4. Adjust fixture to desired vertical angle.
5. Tighten the Vertical Adjustment Screw using the 3/16" hex tool. Do not over tighten!

#### Horizontal Adjustment of Fixture:

1. Loosen the Horizontal Adjustment Screw using a 3/16" hex tool – do not remove screw!
2. Grab fixture Body and gently rotate to break grip of tapered clamp lock.
3. Adjust fixture to desired horizontal angle.
4. Tighten Horizontal Adjustment Screw using the 3/16" hex tool. Do not over tighten!

#### Re-lamping and/or accessory maintenance:

1. Loosen the five Cap Screw's using a 5/32" hex tool.
2. Remove Cap. Note: A small non-marring flat bladed screwdriver may be used to pry off Cap.
3. Pull Lens Gasket, Lens, and Accessories (if any) out of Body. A small flat bladed screwdriver may be used to pry the Lens Gasket away from the Body. Lens Gasket is soft, be very careful not to cut or rip.

#### For re-lamping:

- a. Unscrew the lamp from socket.

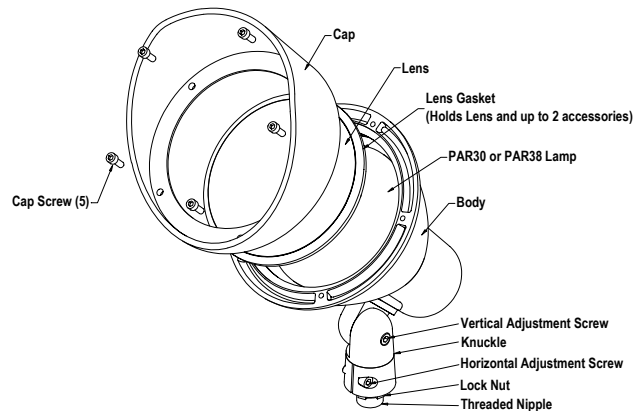

- a. Remove lamp from Body. Note: If lamp is too large to get fingers around, use two screw drivers to lift lamp out of body.
- b. Inspect the socket for any damage.
- c. Screw new lamp in. (Make sure fixture is rated for new lamp by reading fixture label.)

#### For accessory maintenance:

Note: The Lens Gasket holds the Lens and Accessories, acting as a lens seal and an accessory holder.

- a. Remove Accessories from Lens Gasket, being careful not to damage Lens Gasket.
  - b. Inspect Lens Gasket, Lens, and Accessories for damage. Replace if necessary.
  - c. Clean Cap and Accessories with a clean, damp cotton cloth.
  - d. Carefully install new Accessories into Lens Gasket, being very careful not to damage it. **Note: read fixture label or submittal for accessory and wattage limitations!**
5. Inspect Lens Gasket for damage. Replace if necessary.
  6. Clean sealing surfaces on Body and Cap with a clean, damp cotton cloth.
  7. Set Lens Gasket (with Lens and Accessories in it) into the Body, with the Lens facing out.
  8. Set the Cap on top of the Lens Gasket, with mount holes aligned to threaded holes in Body.
  9. Install five Cap Screws and tighten in a criss-cross pattern until Cap is fully seated on Body. Do not over tighten screws!